

· W I L L I A M S ·  
**BUTCHERSTABLE**  
METZGEREI & RESTAURANT

# LET'S CELEBRATE

Your Event at Williams ButchersTable Zürich



Williams ButchersTable is a butchery as well as a restaurant at the same time. It's old school yet very modern, offering a blend of rock 'n' roll and classic traditions. Like the tender fibers of top-quality fillets and special cuts, our enthusiasm for sustainable meat enjoyment runs through all aspects of our daily commitment: from expert advice at the butcher counter to warm hospitality at the long Williams ButchersTable.



54. Rang 2023  
63. Rang 2022



1. Rang 2020



## THE EXPERIENCE

At the ButchersExperience, you will be personally welcomed and guided by our Chief Butcher for an evening of exclusive tasting with his "Signature" selection. Here, you can relax and immerse yourself in the sensual, diverse world of meat enjoyment – and you're sure to learn a few things that you can also apply at home.



Ideal for groups of 8 people or more / available at Hegibachplatz (up to 90 persons) and Bellevue (up to 66 persons)





## THE BUTCHERY

Here, everything revolves around our namesake: the ButchersTable. At the massive oak table, you are literally sitting in the front row: The Chief Butcher personally welcomes guests and treats them directly at the ButchersTable with exclusive special cuts – including meat knowledge to save. Like in "Gangs of New York," you'll feel as if you're in a Butchery in the Meatpacking District, experiencing Zurich with an Oscar-worthy ease and cosmopolitan hospitality.



Ideal for 8 to 12 people / exclusive from 8 persons /  
available at Hegibachplatz and Bellevue





## THE GREEN ROOM

The charm and cozy atmosphere of our Green Room tempt you to simply forget about time. The furnishings and pictures tell avant-garde stories, whisking you away to the crazy 1920s.

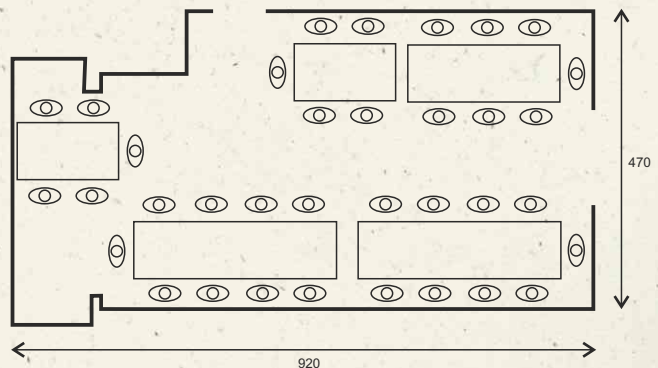

approx. 40m<sup>2</sup> in size / ideal for 30 to 40 people /  
minimum consumption / available at Hegibachplatz





# THE ORANGE ROOM

According to legend, the all-watching bull on the wall is said to have even winked at especially esteemed guests. What else unfolds in the Orange Room, between sumptuous culinary delights and age-old secrets, can be experienced firsthand by convivial gatherings at stylish oak tables and on lavish leather armchairs, set against turn-of-the-century wallpaper.

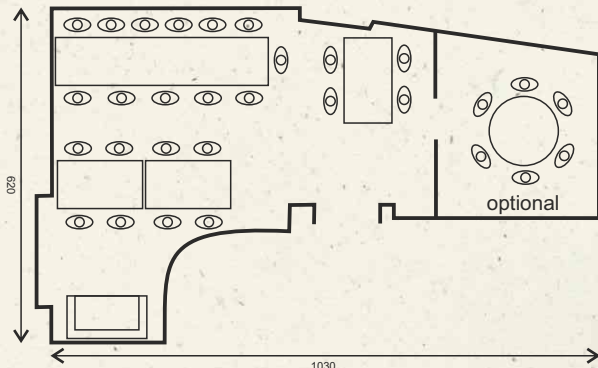

approx. 40 m<sup>2</sup> / ideal for 20 to 30 people / minimum consumption / available at Hegibachplatz



## THE RED ROOM

Truly a venue in the upper echelon:  
The first floor at Williams Butchers Table on Bellevue captivates with a blend of intimacy and vibrancy. In the light-filled 1st Floor with wooden floors, studio-height windows, and a private bar, you can celebrate in private. Yet, you can also accentuate your gathering with the gentle ambient sounds of the restaurant activity on the ground floor. A atmospheric townhouse séparée with an intellectual touch.

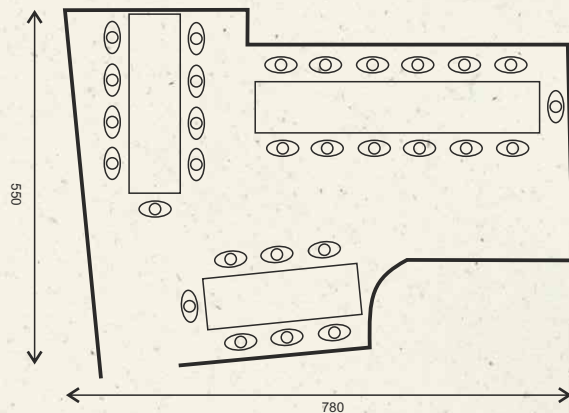

approx. 40 m<sup>2</sup> / ideal for 20 to 30 people / minimum consumption / available at Bellevue





# THE LOUNGE

The sophisticated clinking as large ice cubes floating in weightly single malt glasses, coupled with the spicy-sweet aroma of a Cohiba. The private club ambiance in the lounge makes both women's and men's hearts race and allowing them to party all night long like bohemians from early London times. All this happens around the long oak table with leather chairs, cozy Chesterfield sofas, and a small private bar.

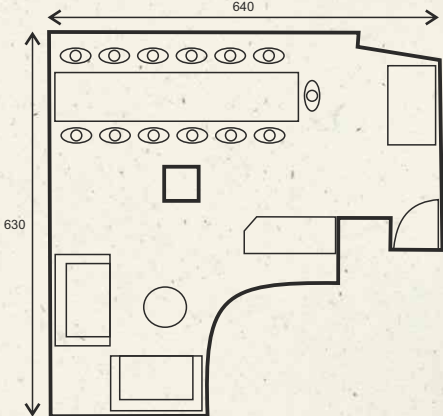

approx. 30 m2/ ideal for 8 to 14 people / minimum consumption / available at Hegibachplatz



# THE SECRET ROOM

„What happens here, stays here...“.

Next to the Orange Room, you'll find the 'hidden chamber' featuring a circular table for six – an ideal, intimate space for discreet conversations, an entertaining night with friends, or a tranquil dinner in a tight-knit circle.

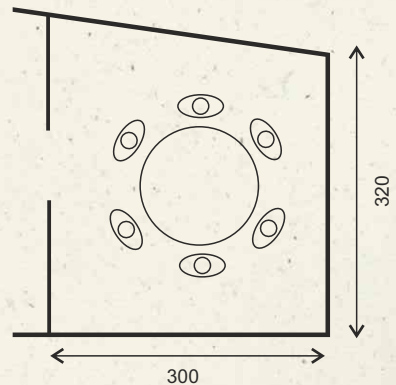

approx. 10 m<sup>2</sup> / ideal for 4 to 6 people / minimum consumption / available at Hegibachplatz





# THE TERRACE

At Hegibachplatz, opulent hydrangeas and fragrant herb bushes flank the secluded ButchersTable garden in the heart of Zurich's Riesbach district. Uncomplicated and well-maintained, the outdoor area complements our event options with a spacious open-air alternative.



Garden terrace at Hegibachplatz: up to 70 people.

Terrace Bellevue: up to 45 people





# SOME IMPRESSIONS



Sharing Plates



Tête-à-Tête



Business

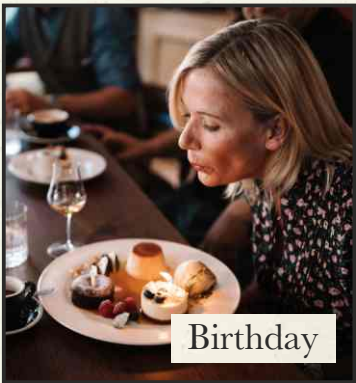

Birthday



Bone Shot





# THE MENU

Happiness doesn't require much: At Williams ButchersTable, we intentionally keep the menu concise, ensuring that everything we serve is of exceptional quality. We exclusively source our meat from LUMA Delikatessen, prepare our startes, sides, and desserts freshly every day, and our wine comes from established wine suppliers.



## ButchersExperience FIRST TASTE

Surprise from the Butchery

### Vorspeise

Salat, Markbein & Boneshot

### Hauptgang

Swiss Prime Cut

Handselected  
Swiss Beef Special Cut

Black Angus Special Cut

### Beilagen

Signature French Fries &  
zwei frisch zubereitete Gemüse

### 85.- pro Person

(exkl. Dessert & Getränke)

\* insgesamt 240g Fleisch pro Person

## ButchersExperience CLASSIC

Surprise from the Butchery

### Vorspeise

Salat, Markbein & Boneshot

### 1. Hauptgang

Luma Pork &  
Black Angus Prime Cut \*

### 2. Hauptgang

Zwei verschiedene  
Black Angus Special Cuts \*

### Beilagen

Signature French Fries &  
zwei frisch zubereitete Gemüse

### 100.- pro Person

(exkl. Dessert & Getränke)

\* insgesamt 280g Fleisch pro Person

## ButchersExperience CARNIVORE

Surprise from the Butchery

### Vorspeise

Salat, Markbein & Boneshot

### 1. Hauptgang

Morucha Côte de Boeuf &  
Luma Beef Prime Cut

### 2. Hauptgang

Black Angus Special Cut &  
Handselected Swiss Beef Special Cut\*

### Beilagen

Signature French Fries &  
zwei frisch zubereitete Gemüse

### 130.- pro Person

(exkl. Dessert & Getränke)

\* insgesamt 320g Fleisch pro Person

We look forward to discussing and planning your event with you personally. You can find the current menu and extensive wine list [here](#).





## HEGIBACHPLATZ



### Capacity

A total of up to 100 seats when you have the restaurant exclusively for your event. Seating capacity per room: Butchery 12 / Green 40 / Orange 30 / Lounge 14 / Secret 6.  
Garden terrace: 70 seats

### Contact

For all your inquiries please contact us directly at phone 044 577 56 88,  
[hegibachplatz@williamsbutcherstable.ch](mailto:hegibachplatz@williamsbutcherstable.ch)

### Adress

Williams Butcherstable am Hegibachplatz,  
Neumünsterstr. 34, 8008 Zürich,  
phone 044 577 56 88

### Planning / Entertainment / Flowers / Technology

Please inform us if you need assistance with planning, finding suitable entertainment, decoration, or technical elements for your event. We are happy to help.

### Cancellation policy

A cancellation is possible up to 2 weeks before the event. After that, 50% of the selected ButcherExperience will be charged. (as the meat is specially ordered, prepared, and portioned for your event. additional butcher staff is scheduled, and seats are reserved).

Minor menu adjustments are possible up to 2 business days before the event.

## BELLEVUE



### Capacity

A total of up to 70 seats when you have the restaurant exclusively for your event. Seating capacity per room: Butchery 12 / Green 28 / Red 30.  
Terrace: 44 seats

### Contact

For all your inquiries please contact us directly at phone 044 506 75 06,  
[bellevue@williamsbutcherstable.ch](mailto:bellevue@williamsbutcherstable.ch)

### Adress

Williams Butcherstable am Bellevue,  
Schiffände 6, 8001 Zürich,  
phone 044 506 75 06





## HEGIBACHPLATZ

### getting there by car

Parking Garage "Feldegg", Riesbachstrasse 7 (8 minutes on foot) Parking available in the neighborhood (white and blue zones). After 19:00, two B&O parking spaces are available opposite our entrance. Limited parking spaces on our terrace during winter.

### getting there by public transport

The Hegibachplatz stop is easily and quickly accessible by the Forchbahn, Tram Line 11, or Bus Lines 31, 33, and 77. The bus ride from Zurich Main Station with Bus Line 31 takes only 10 minutes, while the tram ride from Stadelhofen Station with Tram Line 11 takes only 3 minutes.

## BELLEVUE

### getting there by car

Parking facilities within a 5-minute walk:  
"Hohe Promenade" (Rämistrasse 22a, with XL parking spaces)  
"Opera" (Schillerstrasse 5)  
"Bellevue Garage" (Stadelhoferstrasse 42, until 23:30h)

### getting there by public transport

From Zurich Stadelhofen Station: Only 5 minutes on foot.  
From Zurich Main Station: 15 minutes on foot or take Tram Lines 4 and 7 for a 7-minute ride to the Bellevue stop.

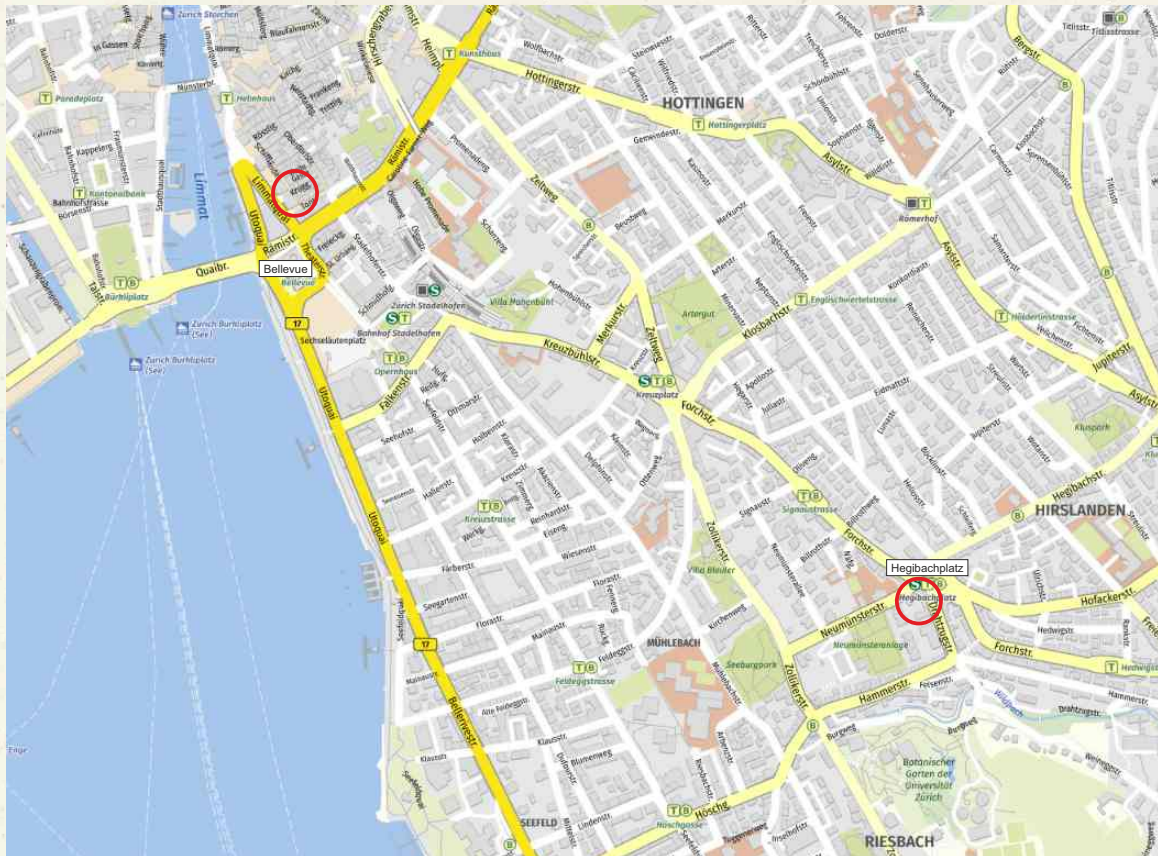

Additional information and photos can be found on our website [www.williamsbutcherstable.ch](http://www.williamsbutcherstable.ch). We look forward to a fantastic event with you and your guests!

Your Williams Butcherstable Team

• WILLIAMS •  
**BUTCHERSTABLE**  
METZGEREI & RESTAURANT